

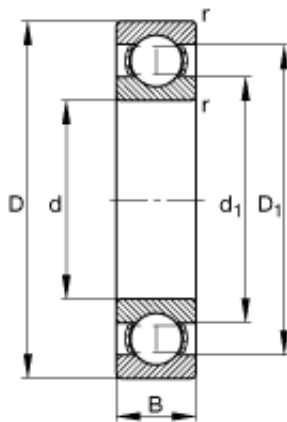

BEARING PRECISION AXLE CORP.



50 mm x 130 mm x 31 mm FAG 6410 Single Row Ball Bearings

Bearing No. 6410

Size	50x130x31 mm
Bore Diameter	50 mm
Outer Diameter	130 mm
Width	31 mm
d	50 mm
D	130 mm
B	31 mm
D_1	108,4 mm
$D_{a \max}$	116 mm
d_1	81,6 mm
$d_{a \min}$	64 mm
$r_{a \max}$	2,1 mm
r_{\min}	2,1 mm
m	1,96 kg / Weight
C_r	89000 N / Dynamic load rating (radial)
C_{0r}	52000 N / Static load rating (radial)
n_G	7900 1/min / Limiting speed
n_B	7200 1/min / Reference speed
C_{ur}	3500 N / Fatigue limit load, radial

6410 Bearing 2D drawings and 3D CAD models